



Easy Photo-ID70
£1,199 + VAT
Starter Kit
£300.00 + VAT

easy photo-ID70

Mitsubishi's Easy Photo-ID70 provides a complete, cost effective, one stop digital photo printing solution for small to medium sized retailers. An instant photo printing system that offers a range of services including ID photo printing and CD/DVD burning. Easy to install and operate, this photo system has been designed for operators use and consists of a touch screen monitor, new software programme and one of Mitsubishi's quickest dye sublimation printers – the CP-D70DW-U. Compact in design but quick in speed, Easy Photo-ID70 provides vibrant, bleed to edge photos in just seconds and can fit discreetly into any installation environment. Ideal for independent retailers, the ID automatic detection setting and multi-copy tool enables the production of instant ID photos, simpler and faster than ever before.



Operators can upload images from a PTP protocol and edit the ID photos from one single screen. It is that easy, it is that simple!

Starter Bundle includes:

- NEW Easyphoto kiosk & ID terminal
- NEW CP-D70DW-U dye sublimation photo printer
- 4" x 6" Media 'Bumper Pack' – 12 rolls of CK-D746 media (4,800 prints)



Mitsubishi Special package price £1,499 + VAT SRP. Only 6p per print cost!!

Easy Photo-ID70	
Screen size	10.4" Touch screen
System	Celeron 2.2Ghz, RAM 1Gb, 4Gb CF
Dimensions (W x H x D)	Approx 300 x 250 x 200mm (Terminal) Approx 275 x 446 x 170mm (Printer)
Weight	7.5kg (Terminal) / 12kg (Printer)
Reading/input	Compact Flash type I/II, Smart media, Memory stick / MS PRO, Secure Digital Card, MM Card, IBM micro drive, Mini SD card, Memory stick DUO, XD card, USB, CD / DVD Rom, Bluetooth™ for telephone
Basic functions in photograph processing	Red eye correction, Cut, Frame, Zoom, Merger, Light, Contrast, Colour / Sepia / Black and White, Colour regulation according to ICC profiles
Iq software (regulating image quality for all printers)	No
Statistics (local or remote)	Local
Possibility of scanner connection	No
Receipt printer	Optional
Compatible printers	CP-D70DW-U
Maximum number of printers connected	1
Printing formats available in cm	10 x 15
Printing formats available in inch	4 x 6

Easy Photo-ID70	
Basic EasyID system	
Copies: ID photo different size masks	
Recording on DVD/CD	
Optional Easy Kiosk-ID70 services	
Easygreetings (optional) Greetings & Frames	
Easycollage (optional) Collage 10 x 15cm	
Easymosaic (optional) MOSAIC POSTER Made up of various photos cut out of one and the same picture	
Easycalendar (optional) Calendars (Annual – 12 months on one page) Easycalendar (1 page per month) 10 x 15cm	
Easypackdeco Easyphoto Software Pack Deco (optional)	
Includes following functions: EASYCALENDAR Easygreetings Easycollage Easymosaic	
Basic EasyID System Operator mode only	

Return on Investment Calculator		
		Per Year
Average number of ID photos per day	5	1550
Average number of 4" x 6" photos per day	15	4650
Average number of days open per year	310	
Price per ID photo	£5.50	£8,525.00
Price per 4" x 6" photo	£0.30	£1,395.00
Equipment cost	£1,499.00	
Turn over year one		£9,920.00
Net income year one		£8,421.00

*All price quotes exclude VAT. All figures quoted in the ROI are based on 'approximates' and are designed as a guide only. Actual ROI achieved is dependent on number of actual trading days and sales.

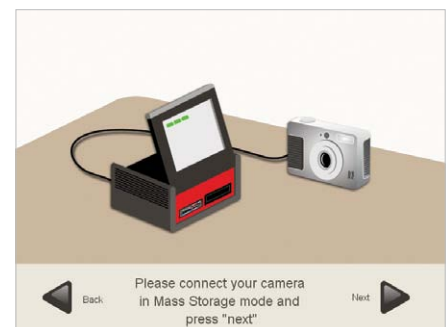

Image inputs: Standard from card reader, Mass storage device protocol compatibility (using USB Connection), PTP Protocol compatibility (using USB Connection)

<p>Services:</p> <ul style="list-style-type: none"> • Easy to Install: Plug and Play • Easy to Use: Simple and Friendly • Compact, sleek design: Can fit discreetly into any location • Instant prints: Mitsubishi's CP D70DW-U printer produces high quality photos in seconds <p>Software included:</p> <ul style="list-style-type: none"> • Prints from all major media cards, USB, PTP protocol and CD/DVD • Class leading printer providing high quality 4" x 6" photographs in seconds • Production up to 400 prints/hour (max 1 printer CP-D70DW-U) • Bio-metric software automatically adjusts images to fit passport requirements • Advanced input device: PTP protocol compatibility using USB connection for mass storage 	<ul style="list-style-type: none"> • Different layouts: users can add new formats and includes the latest composite files • Simple workflow function: adjustments can be made on just one single screen • Multi-copy: print multiple ID photos quickly and easily • Automatic source: operators can select the automatic functions in order to make the workflow quicker and easier <p>Optional Software and accessories:</p> <ul style="list-style-type: none"> • Optional calendar, collage and mosaic functions • Optional in-store point of sale material is available • Receipt printer & validation keyboard <p>Features:</p> <ul style="list-style-type: none"> • Biometric masks for ID photos • Compact design terminal • 10" touch screen • Copies CD's and DVD's
---	--